



Hot shell fit-out
2007

COST
£ 1.5m

KEY FACTS
6 screens
1,500 seat capacity

SERVICES
Project Management
FF&E procurement

FOYER REFURBISHMENTS

Sheffield
Finchley Road
Fulham Broadway
Leeds
Bassingstoke

Main Foyer



Vue Lancaster Cinemas, UK & Associated Refurbishments

August 2007

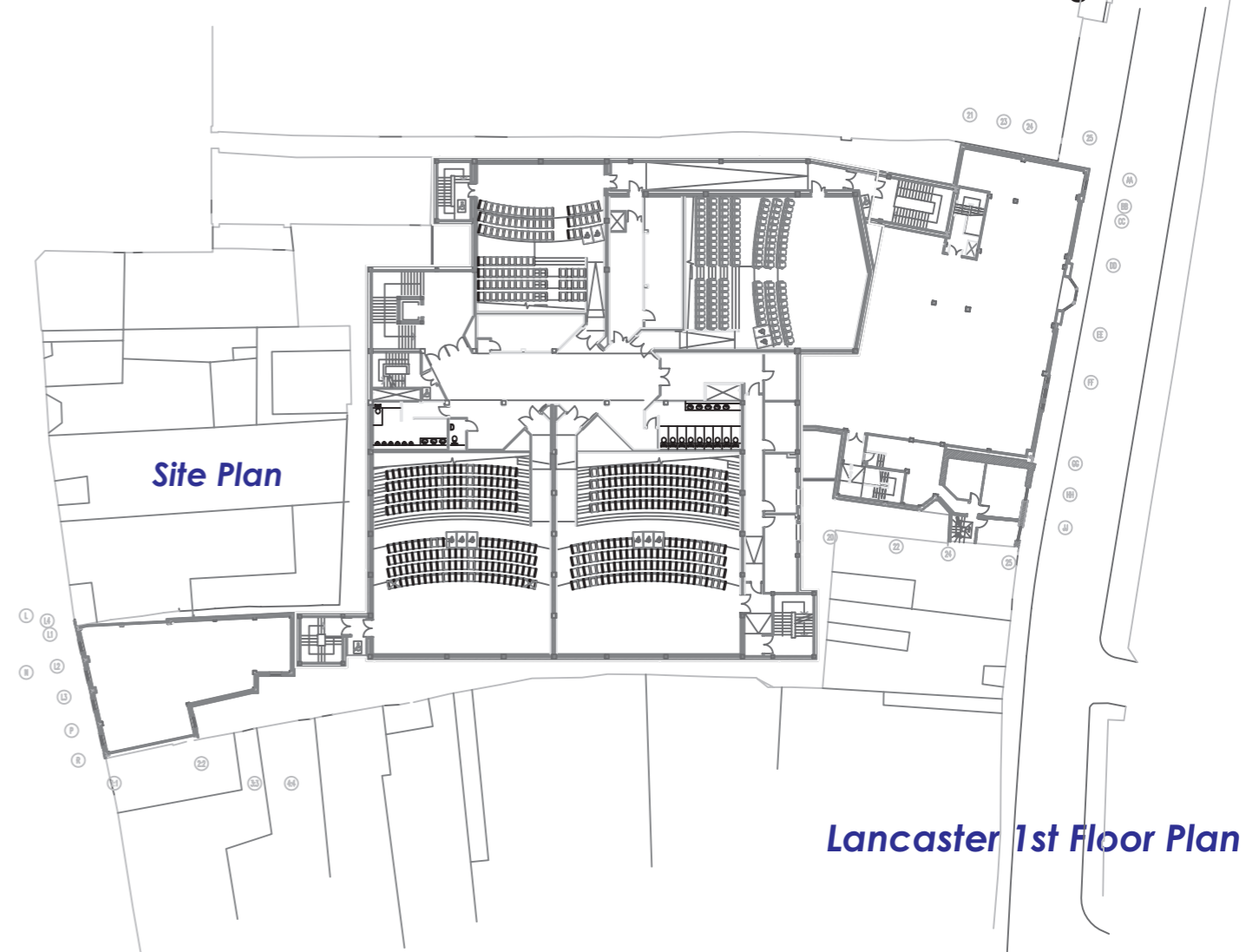

We provided VUE Cinemas with project management services for the re-modelling of concurrent foyer and concession stands across 5 sites during late 2007 & 2008.

We liaised with external interior design consultants, fit-out contractors internal procurement departments and local on site management teams providing weekly briefings and progress reports to senior management.



We were employed by Village Roadshow Limited Australia, to complete their fit-out obligations of a landlords "hot shell". The cinema had been "moth balled" for 4+ years.

We engaged specialist fit-out contractors and specialist vendors to complete the obligations delivering an operating cinema that was by completion branded, managed and operated by VUE Entertainment.

